

30 **CVEREL**

THE WORLD IN A CLICK

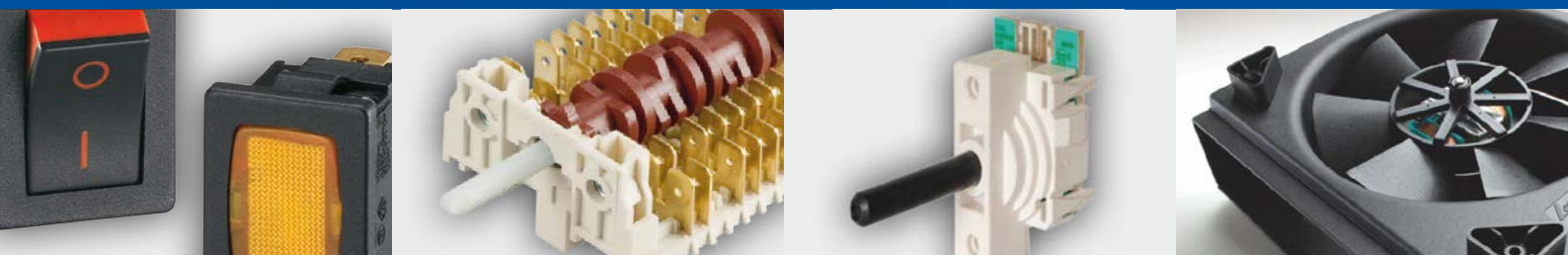

SELECTORS



Dreefs

 **SIGNAL LUX**

givem

M MOLVENO

 **KAUTT & BUX**

Selectors

04

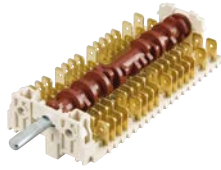

HE

176

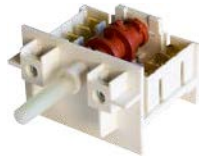

5HE 7TAKT

180

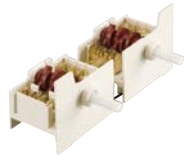

5HE 7TAKT DUO

182



HT

184

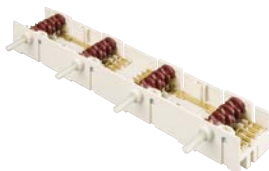

5HE 4 BLOCK

186

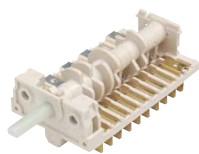

CH

187



2CH WITH ENCODER

188

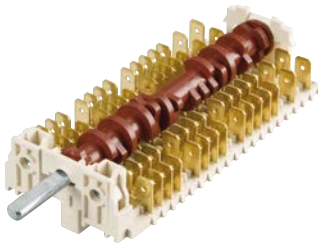

HE



TYPICAL APPLICATIONS	Function selector switch
WIRING DIAGRAMS	2 - 14 positions Rast 5 connectors
GWFI	850 °C
GWIT	750 °C

Rotary switches with a wide range of configurations. 6 types of housing available, different for the maximum number of contacts. HE series is automatically assembled in a great variety of configurations.

- Function selector switch
- Child lock - push to turn feature on demand
- Coupling with encoder available
- Flexibility of wiring diagrams
- Different "click" or frictional feeling
- Metal or plastic shafts with different lengths: 12,5 - 46 mm (standard shafts protude: 23 mm)

EXAMPLE OF 11HE WITH 8 CONTACTS

Easy wiring with multiple plug (Rast 5) or single terminals 6,3 mm

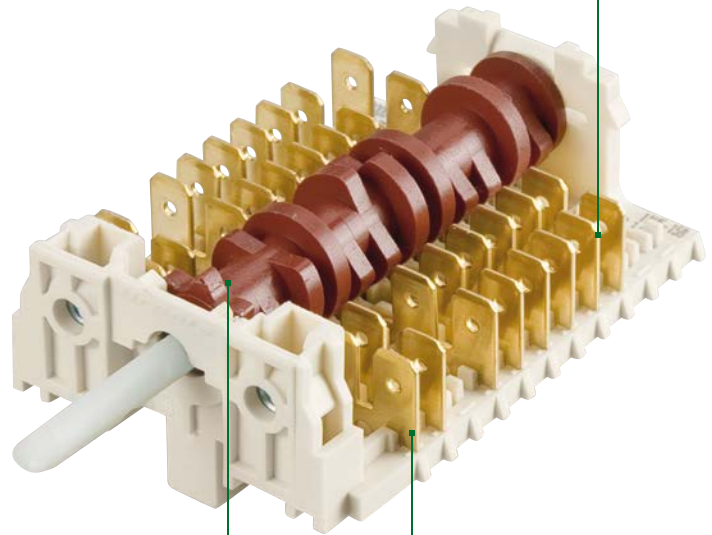

2 - 14 positions

Standard double contact

Rating

16 A / 250 VAC - 10E3
 12 A / 400 VAC - 30E3
 0,25 A / 250 VAC - 30E3
 T150 °C
 According to
 EN61058-1 standard

16 A / 250 VAC
 T120 °C
 According to
 UL 1054

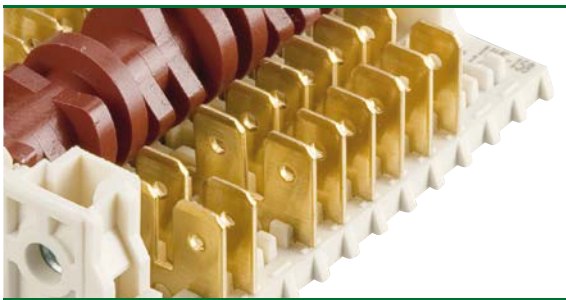

TYPICAL TERMINALS

- Single terminals
- Double terminals
- Chopped
 - left
 - center
 - right

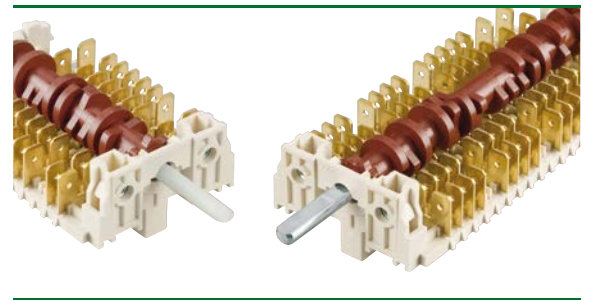

TYPES OF SHAFT

Plastic

Metal

DIMENSIONS

Standard version

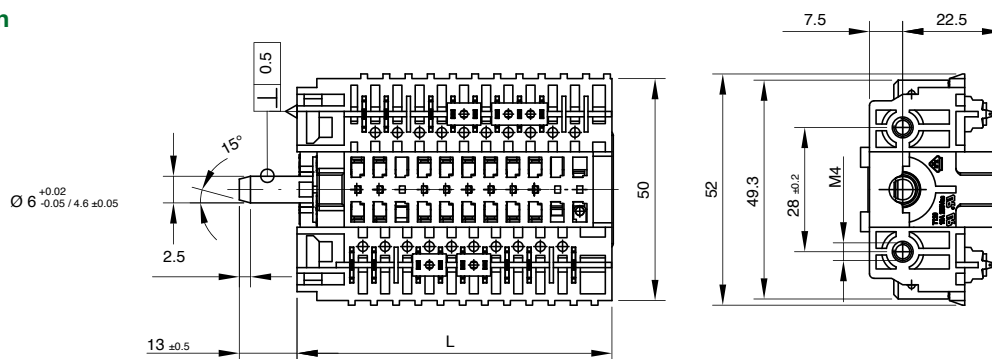

Thermostat version

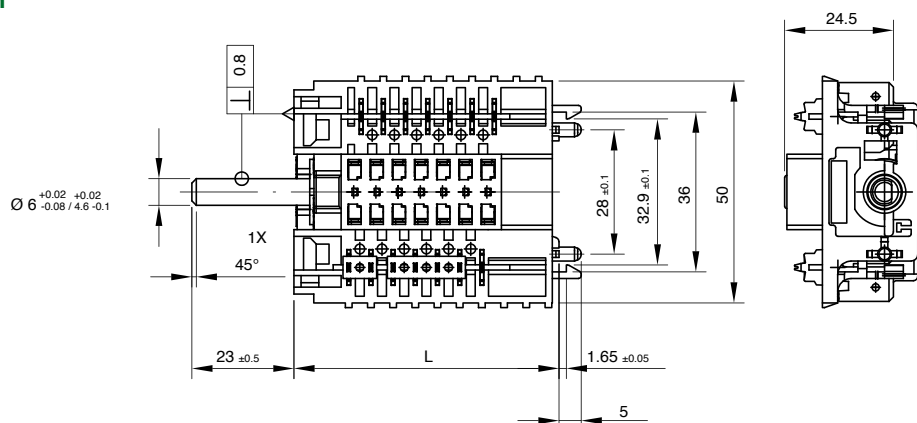

TECHNICAL FEATURES

Version	No. contacts	Length	
		L	L thermostat version
3HE	up to 3	30	38
5HE	up to 5	40	48
7HE	up to 7	50	58
11HE	up to 11	70	78
15HE	up to 15	90	98
19HE	up to 19	110	118

OPTIONS

Higher number of contacts, multiple versions, possibility to use accessories are the main features of HE series.

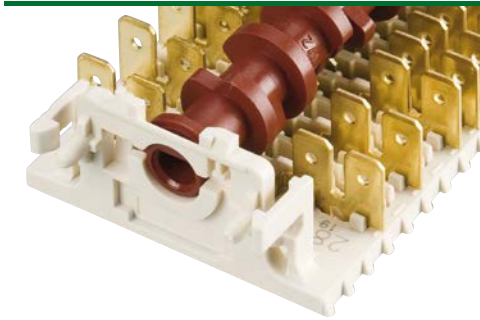

Body with accessory holder

- Possibility to use in conjunction with a capillary thermostat or an encoder

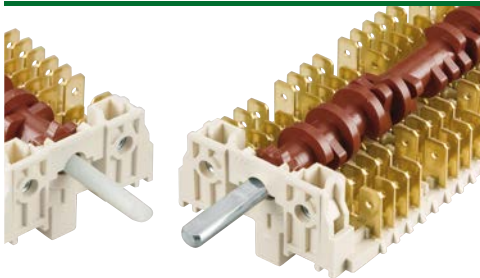

Shaft

- Metal or plastic shaft with length on demand (12.5 - 46 mm)
- Standard shaft length: 23.5 mm

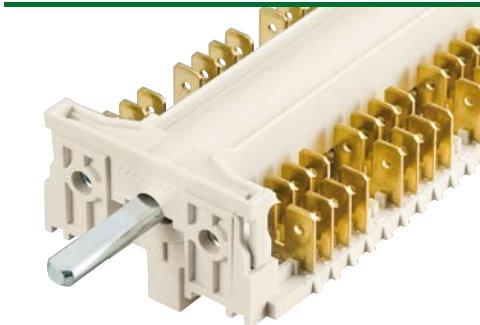

Cam cover

- Cam cover protects cam and contacts from dirt and waste of cooking.
- Note: cam cover is available for 11 and 19 versions.

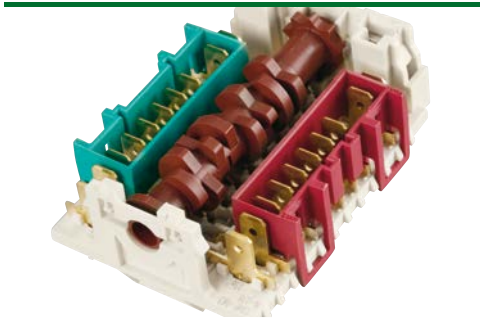

Terminal housing

- Various dimensions of terminal housing: for 2 - 4 - 6 connections.
- Terminal housing available only for single terminal version.

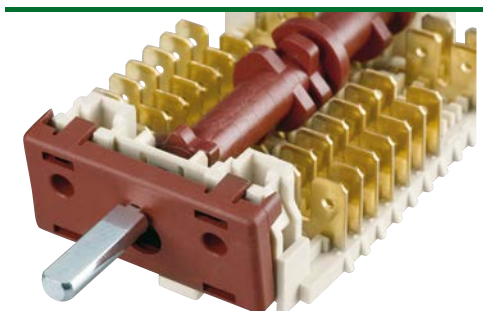

Child lock - push to turn feature

- Push to turn safety feature available.

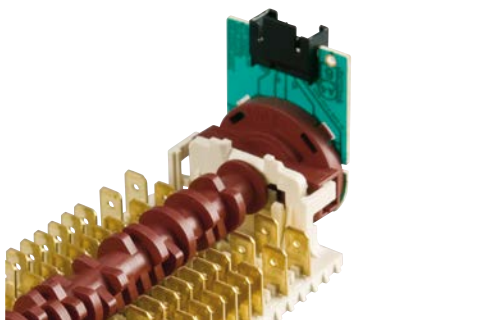

Coupling with encoder

- HE series can be coupled to an electromechanical to control electrical and power signals.

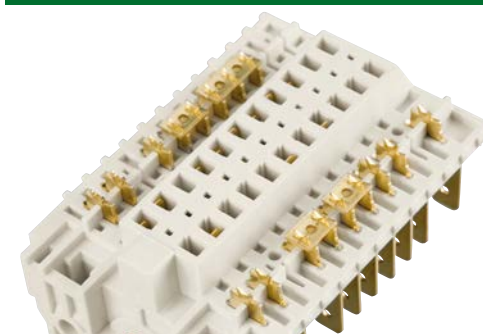

Bridges

- The use of bridges between contacts increases range of combinations.
- For every line the number of bridges can vary between 0 up to 5.
- It can be joined up to 7 contacts.

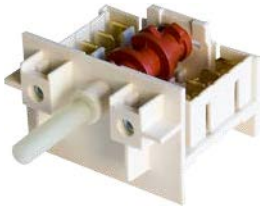

5HE 7TAKT



On demand

TYPICAL APPLICATIONS	Hobs control
WIRING DIAGRAMAS	7 positions
GWFI	850 °C
GWIT	750 °C

Rotary switches with different mounting solution available, 7 positions, with electric rating up to 12A. Ideal for hobs control, with a terminal housing conjuncted to the body.

- Standard connecting with single terminals 6,3 mm
- Different mounting solutions available:
snap-in, nuts or screw fixing
- 30.000 cycles
- Plastic shafts with different lengths (16 - 31 mm)

Rating

12 A / 400 VAC 30E3

T150 °C

According to

EN61058-1 standard

16 A / 250 VAC

T120 °C

According to

UL 1054

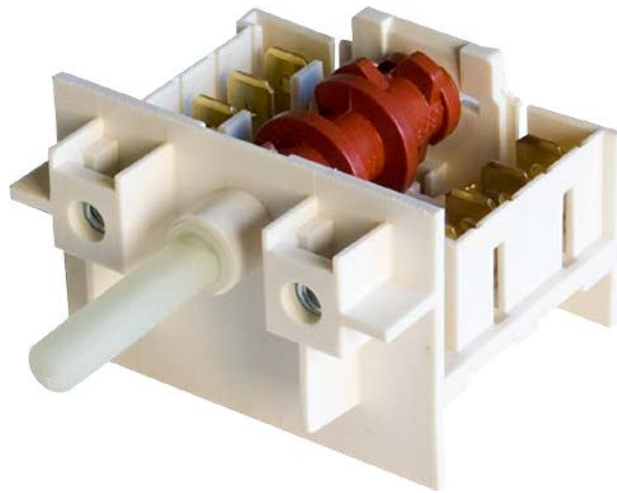

TECHNICAL FEATURES

Rast 6,5 multiple connection.

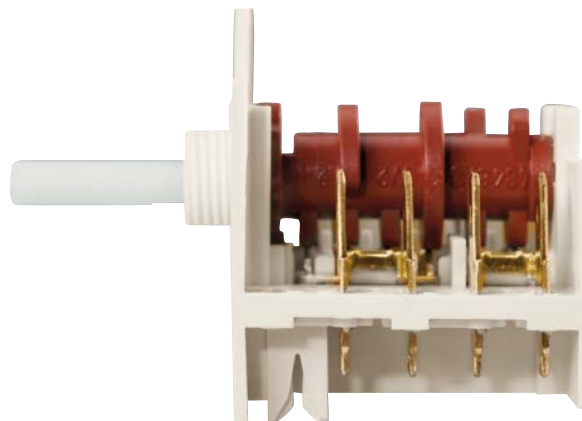

DIMENSIONS

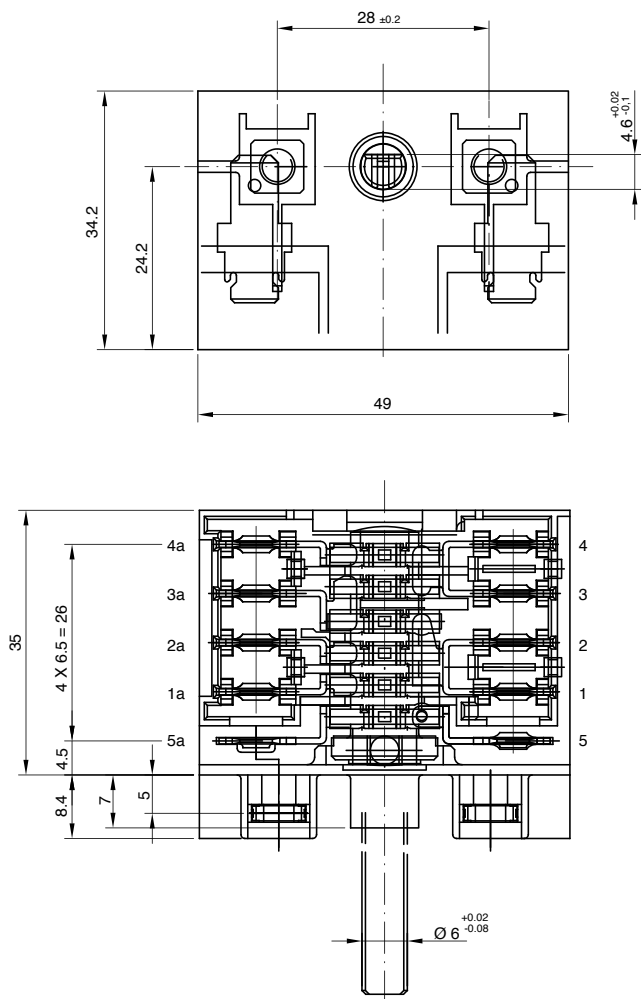

CONTACT SEQUENCE

Pos.	Ang.	P3		P1		P2	
		5a	1a-2a	1a-2a	3a-4a	3a-4a	3a-4a
		5	1	1	3-3	4	
		5	2	2	3-3	4	
0	0°						
1	51,4°	■	■	■		■	■
2	102,8°	■		■		■	■
3	154,2°	■		■		■	
4	205,6°	■		■			■
5	257,0°	■			■		■
6	308,4°	■	■			■	

SOLUTIONS

Nut Fixing



Screw fixing

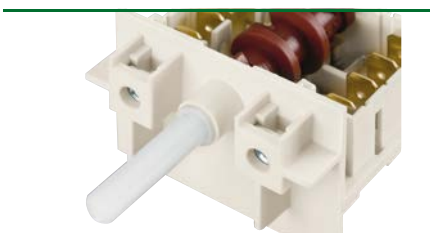

Snap-in fixing



CUT OUT

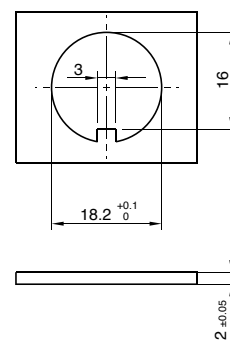
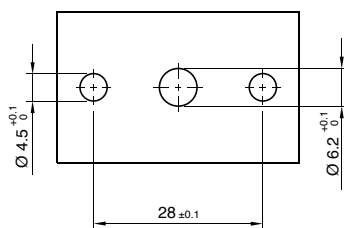
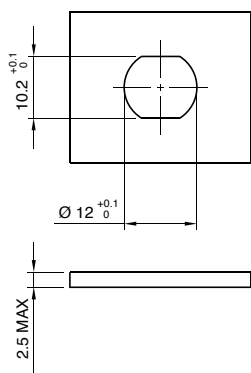

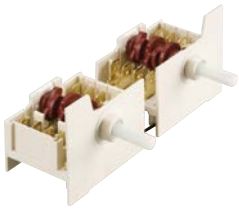

5HE 7TAKT DUO



TYPICAL APPLICATIONS	Hobs control
WIRING DIAGRAMAS	7 positions
GWFI	850 °C
GWFI	750 °C

This series is composed of two 5HE 7TAKT rotary selectors, 3 different distances of axis available (55, 60 and 65 mm). Each selector has 7 positions, electric rating up to 12A and different mounting solutions. Duo block permits to make the wiring easier.

- Standard connecting with single terminals 6,3 mm
- Different mounting solutions available: snap-in, nuts or central mounting
- Metal or plastic shafts with different lengths
- Rast 6,5 multiple connection available
- Metal or plastic shafts with different lengths:
(16 - 31 mm)

EXAMPLE OF 5HE 7TAKT DUO WITH NUTS

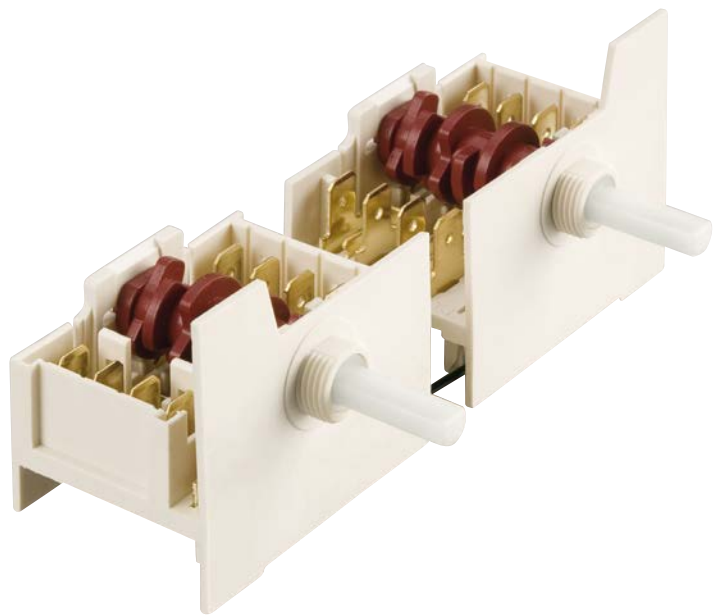

Rating
12 A / 400 VAC 30E3
T150 °C
According to
EN61058-1 standard

16 A / 250 VAC
T120 °C
According to
UL 1054

TECHNICAL FEATURES

Various distances of axis available:
55, 60 and 65 mm.

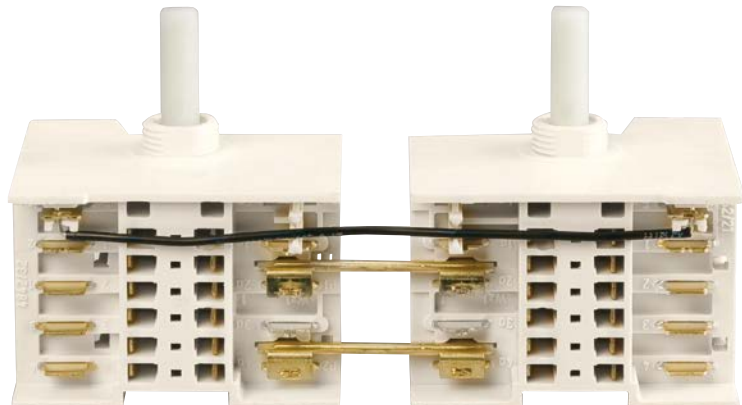

DIMENSIONS

Screw fixing version

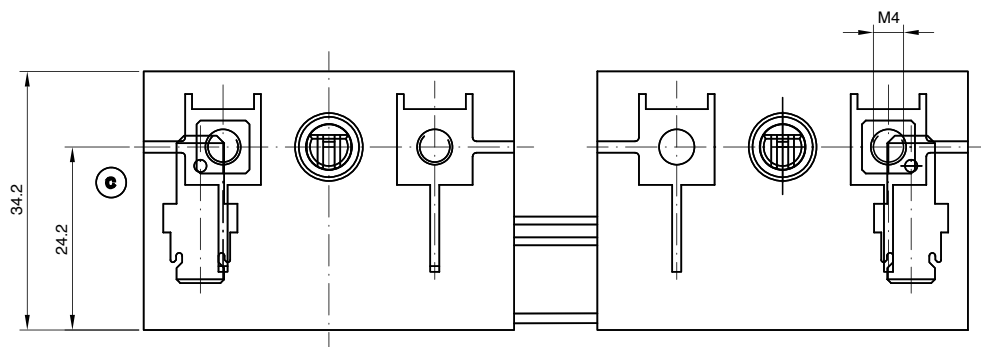

60 mm interaxis version
(55 and 65 mm available)

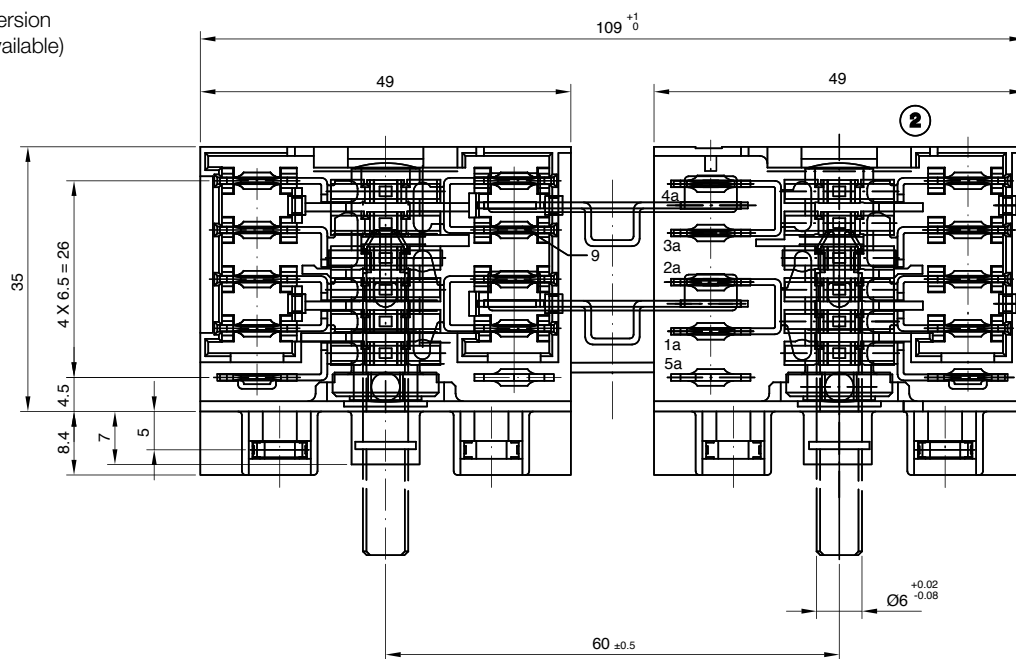

CONTACT SEQUENCE

Pos.	Ang.	P3		P1		P2		
		5a	1	1a-2a	2	3a-4a	3-3	4
0	0°							
1	51,4°	■	■	■		■	■	
2	102,8°	■		■		■	■	
3	154,2°	■		■		■		
4	205,6°	■		■			■	
5	257,0°	■			■			■
6	308,4°	■	■			■		

Pos.	Ang.	5a		1a-2a		3a-4a	
		S	1	2	3-3	3-3	4
0	0°						
1	51,4°	■	■	■		■	■
2	102,8°	■		■		■	■
3	154,2°	■		■		■	
4	205,6°	■		■			■
5	257,0°	■			■		■
6	308,4°	■	■			■	



HT

TYPICAL APPLICATIONS	Electric hobs in freestanding cookers
WIRING DIAGRAMAS	2 standard positions rotary switch
GWFI	850 °C
GWIT	750 °C



7 positions rotary switch, ideal for electric hobs in freestanding cookers. M4 screw mounting and different shafts available. Special sequences with 4 - 5 - 6 positions are available.

- Terminals 6,3 mm
- M4 screw mounting
- Metal or plastic shafts
- With or without signal contact

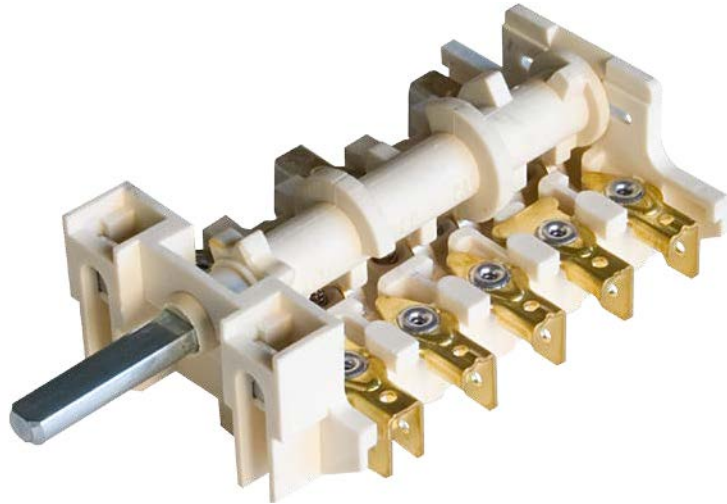

Rating

12 A / 400 VAC - 30E3

T150 °C

According to

EN61058-1 standard

16 (6) A / 250 VAC

T150 °C

According to

UL 1054

OPTIONS

Metal or plastic shaft, with length on demand.

Metal shaft

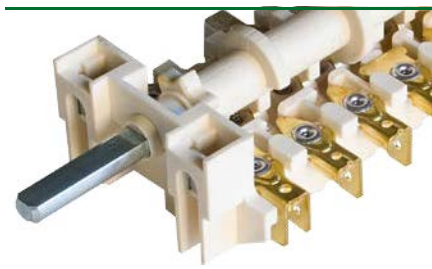

Plastic shaft

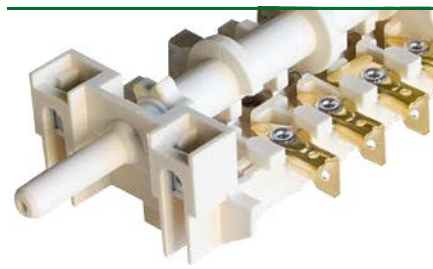

DIMENSIONS

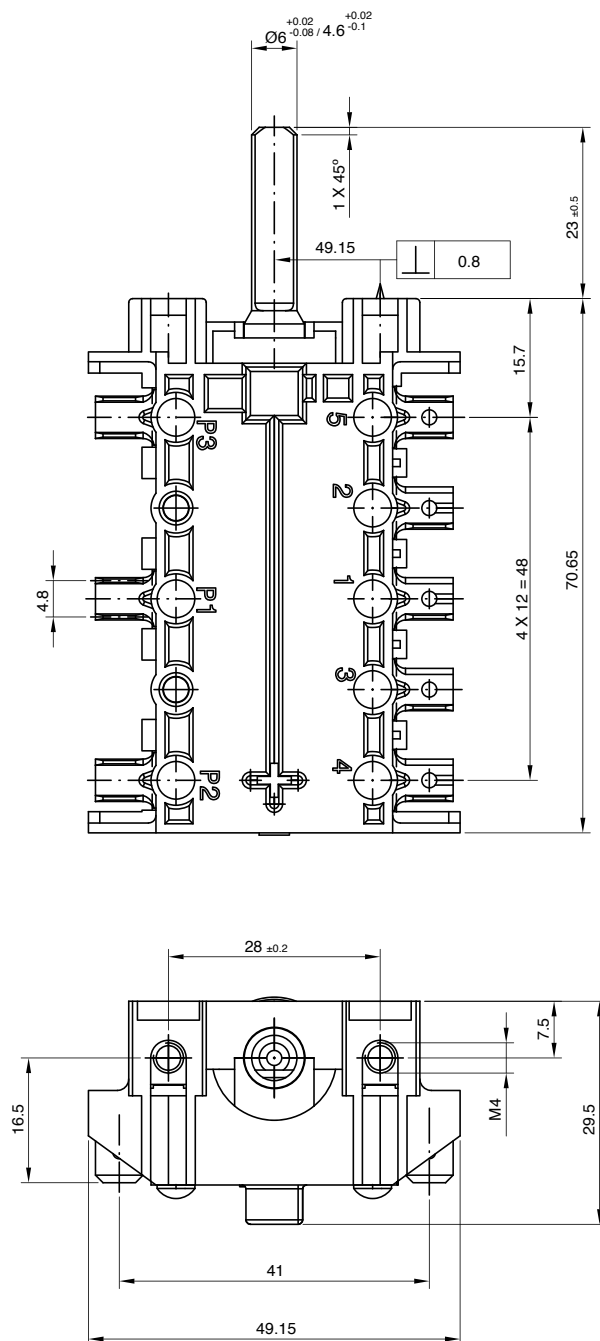

EXAMPLE OF CONTACT SEQUENCE

Pos.	Ang.	5	2	1	3-3	4
		P3		P1		P2
0	0°					
1	$51,4^\circ$	■	■	■		■
2	$102,8^\circ$	■	■			■
3	$154,2^\circ$	■	■			
4	$205,6^\circ$	■	■			■
5	$257,0^\circ$	■			■	■
6	$308,4^\circ$	■		■		■

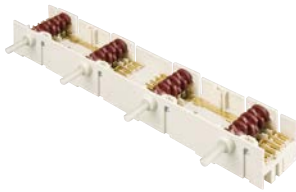

5HE 4 BLOCK

TYPICAL APPLICATIONS	Hobs control
WIRING DIAGRAMAS	7 positions
GWFI	850 °C
GWFI	750 °C



This solution integrates all wirings of four 5HE 7TAKT in a single body; robustness, compactness and easy mounting are its best features.

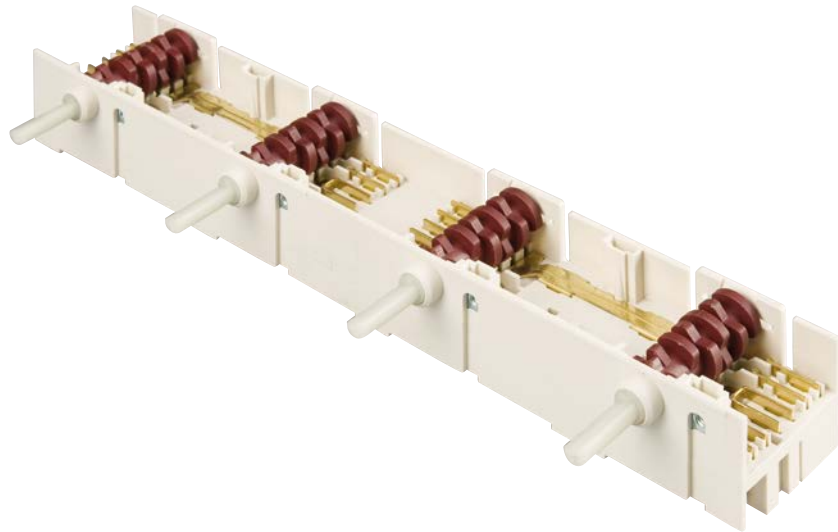

Rating
 12 A / 400 VAC - 30E3
 T150 °C
 According to
 EN61058-1 standard

16 A / 250 VAC
 T120 °C
 According to
 UL 1054

DIMENSIONS

2 versions:

L = 247.35
 D = 65 ±0.2

L = 230.45
 D = 60 ±0.2

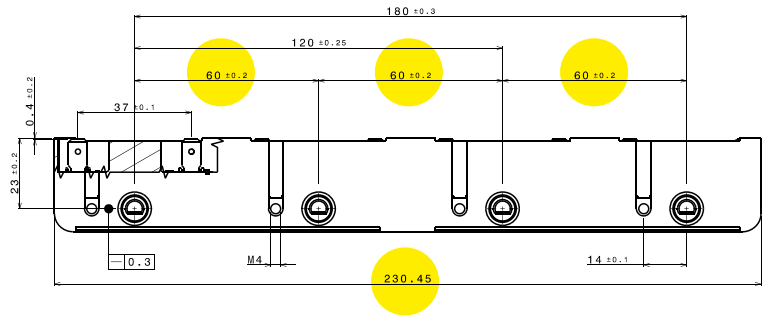
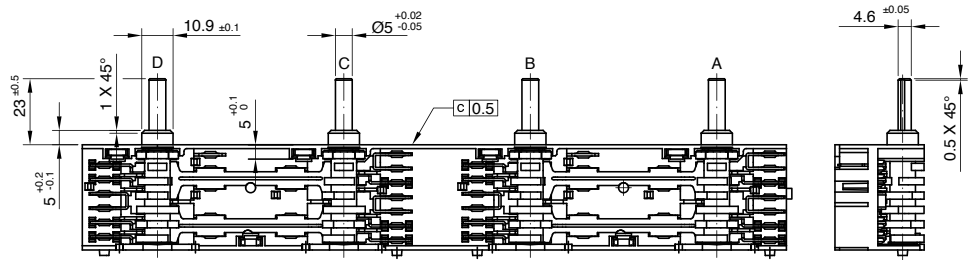



CH

TYPICAL APPLICATIONS	Function selector switch
WIRING DIAGRAMS	2 - 14 positions
CYCLE No.	Up to 30.000
AMBIENT TEMPERATURE	150 °C
GWFI	850 °C
GWFI	750 °C
ADDITIONAL FEATURES	<ul style="list-style-type: none"> ■ M4 screw mounting ■ 26 contacts version available



Thermostat version available

16 (6) A / 250 VAC - 30E3
 16 (8) A / 250-125 VAC - 10E3
 18 A / 250-125 VAC - 30E3
 12 A / 400 VAC - 30E3
 T150 °C
 According to
 EN61058-1 standard

3/4 HP / 125 VAC
 18A / 250 VAC
 16A / 250 VAC
 T125 °C
 According to
 UL 1054

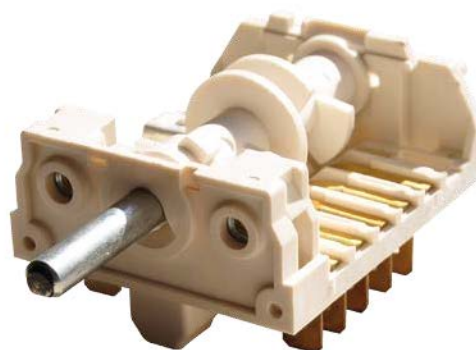

DIMENSIONS

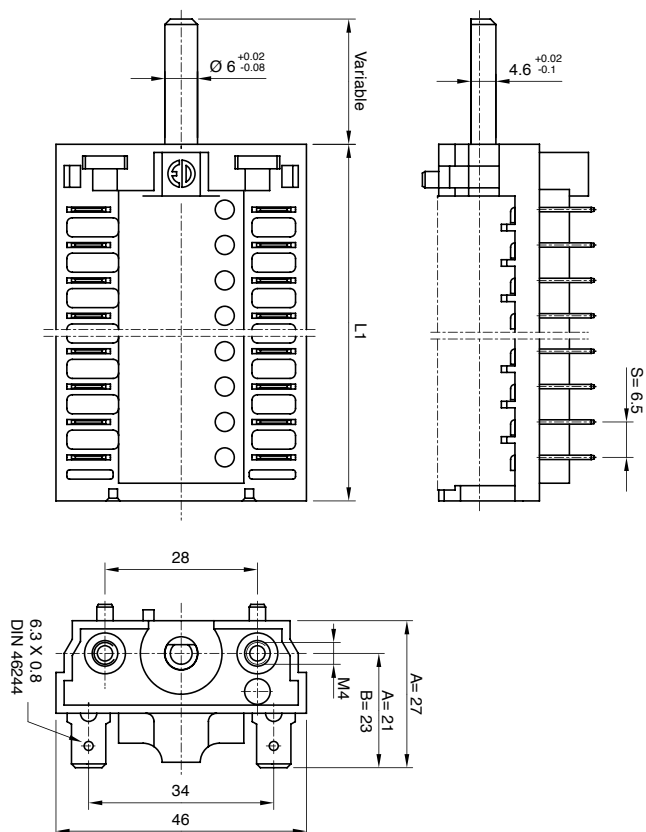

CONTACT SEQUENCE

Basic Version					
Type	Contacts		L1		Version
	16(4)/250ac 6(2)/250ac	6(1.5)/250ac	S=7	S=6.5	
1-CH	1		29,5*		A
2-CH	2		25	36*	A
3-CH	3		32	33	A
4-CH	4		39	39.5	A, B
5-CH	5		46	46	A
6-CH	6		49,5		A
6-CH	6		53	52.5	A, B
7-CH	7			59	A, B
8-CH	8		67	65.5	A, B
9-CH	9			72	A
10-CH	10		81	78.5	A, B
11-CH	11		88	85	A, B
12-CH	12		95		A
13-CH	8	5	S=7	S=6	A
			97		

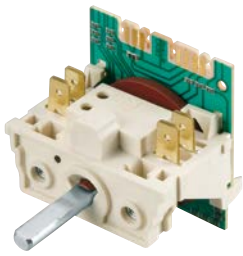

2CH with encoder

TYPICAL APPLICATIONS Electronic and electrical function selector

WIRING DIAGRAMS ■ On demand

CYCLE No. 30.000

AMBIENT TEMPERATURE 85 °C

ADDITIONAL FEATURES ■ Solution combining selector and encoder functions, that allows to improve flexibility and compactness



Solution combining selector and encoder functions, that allows to improve flexibility and compactness.

Rating

16 (6) A / 250 VAC

10 (2) A / 400 VAC

18 A / 250 VAC

6 (4) A / 250 VAC

T 150 °C

According to

EN61058-1 standard

3/4 HP / 125 VAC

16 A / 250 VAC

13.8 A / 250 VAC

T 85 °C

According to

UL 1054

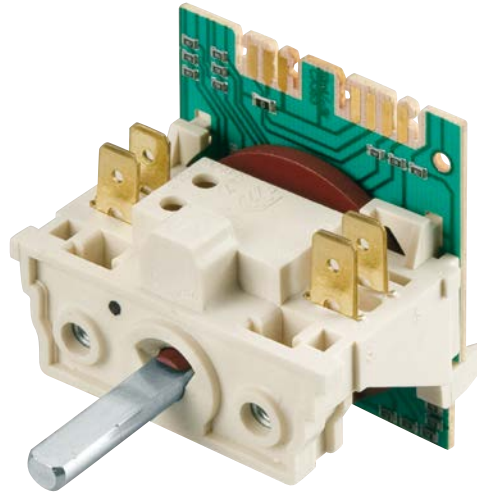

DIMENSIONS

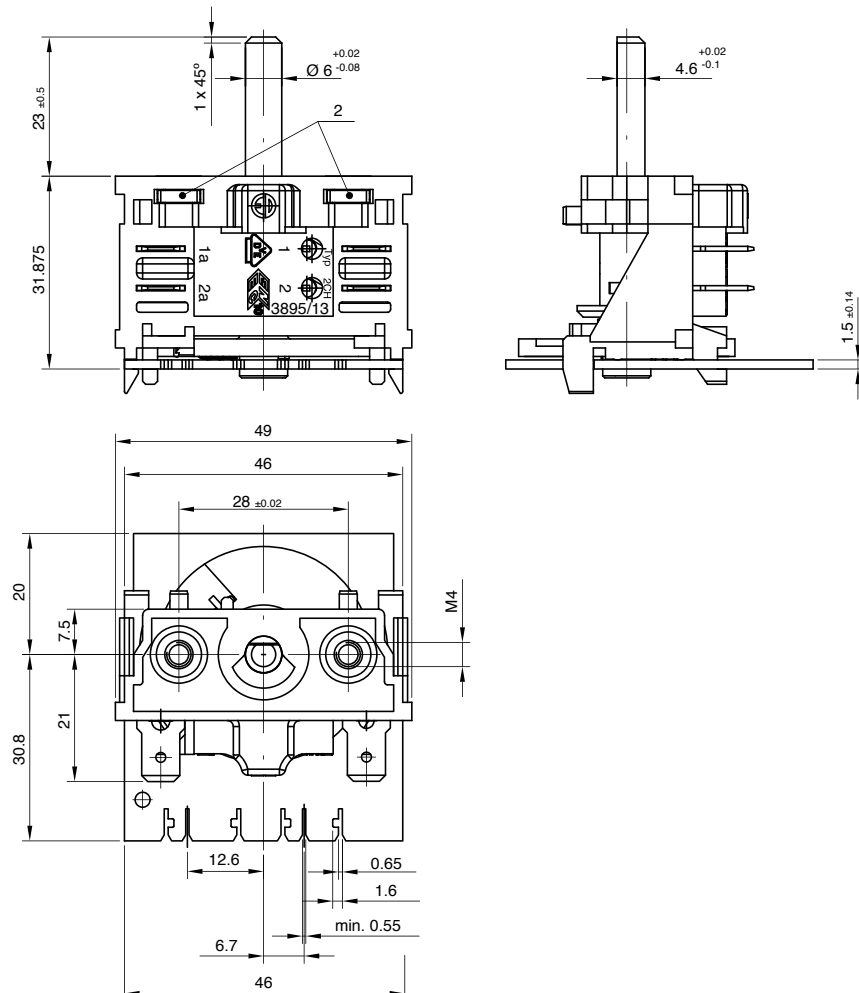

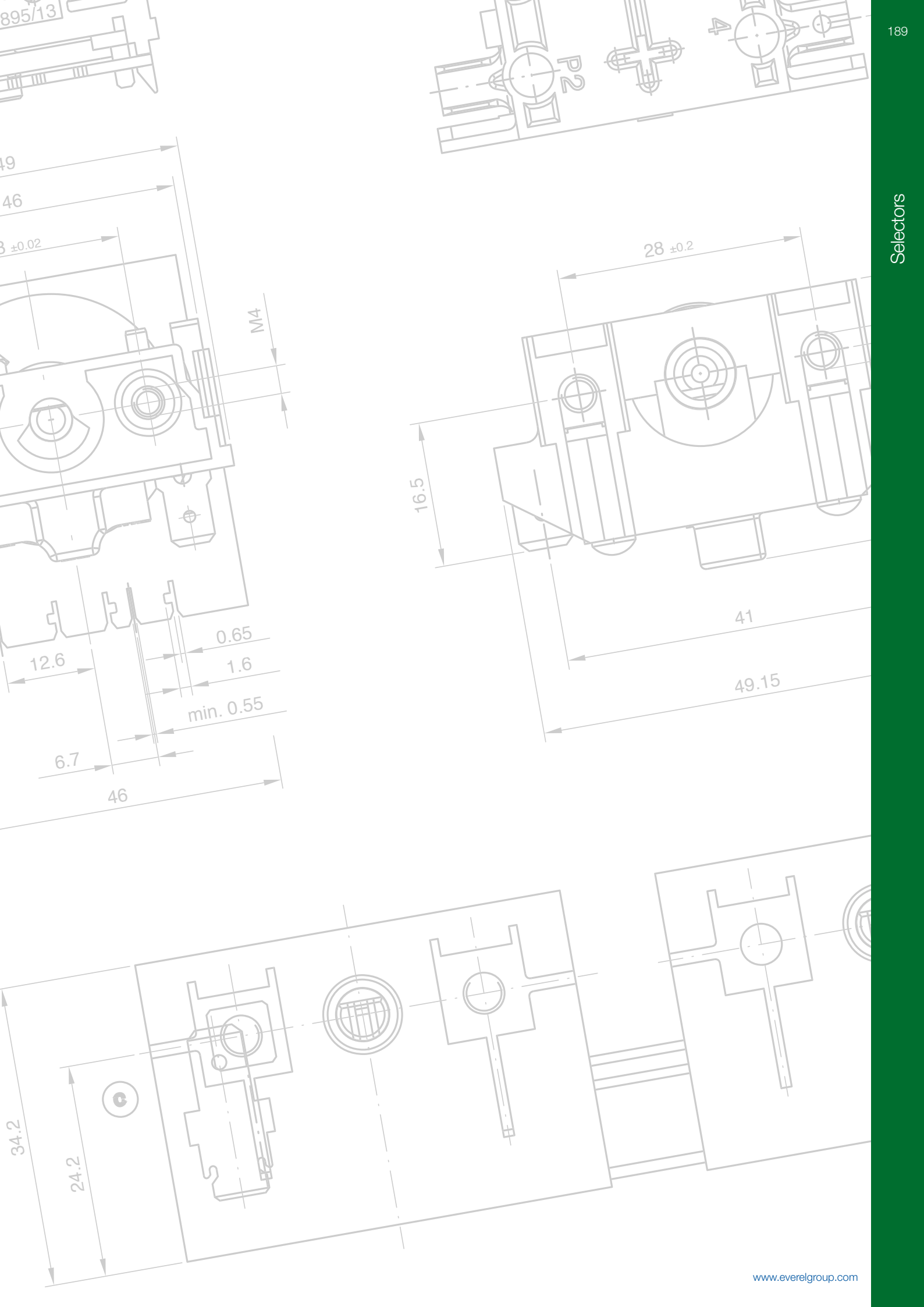



- Headquarter
- Production Site
- Sales Network



Everel Group S.P.A.

[Headquarter - Production Site]
Via Cavour, 9
37067 Valeggio sul Mincio (VR) - Italy
tel. +39 045 6313711
fax +39 045 6313730

Dreefs GmbH

[Production Site]
Ernst-Dreefs-Straße 7
96364 Marktrodach - Germany
tel. +49 9261 9610
fax +49 9261 961248

Everel Romania S.r.l.

[Production Site]
Calea Timisorii 109
Lipova - Arad - Romania
tel. +40 257 563087
fax +40 257 563086

www.everelgroup.com

